

# SITE PLAN

## THE RISE AT BIRCHWOOD AT BRAMBLETON



Van Metre

This rendering is for illustrative purposes only. This is an artist's depiction of the proposed development plans for the project, which development plans are subject to change without notice. The rendering is purely conceptual in nature and should not be relied on in making a decision to purchase. Neither seller nor developer make any representation or warranty of any kind, express or implied, regarding the current or future use of properties surrounding the project or elsewhere in the planned community. This site lies within the Airport Impact Overlay District. Due to its proximity to Washington Dulles International Airport, this site may be subject to aircraft overflights and noise due to aircraft. Current as of 04/13/2021



# SITE PLAN

## THE RISE AT BIRCHWOOD AT BRAMBLETON



Van Metre

This rendering is for illustrative purposes only. This is an artist's depiction of the proposed development plans for the project, which development plans are subject to change without notice. The rendering is purely conceptual in nature and should not be relied on in making a decision to purchase. Neither seller nor developer make any representation or warranty of any kind, express or implied, regarding the current or future use of properties surrounding the project or elsewhere in the planned community. This site lies within the Airport Impact Overlay District. Due to its proximity to Washington Dulles International Airport, this site may be subject to aircraft overflights and noise due to aircraft. Current as of 04/30/2021





# SITE PLAN

## THE LIFTS AT BIRCHWOOD AT BRAMBLETON



Van Metre

This rendering is for illustrative purposes only. This is an artist's depiction of the proposed development plans for the project, which development plans are subject to change without notice. The rendering is purely conceptual in nature and should not be relied on in making a decision to purchase. Neither seller nor developer make any representation or warranty of any kind, express or implied, regarding the current or future use of properties surrounding the project or elsewhere in the planned community. This site lies within the Airport Impact Overlay District. Due to its proximity to Washington Dulles International Airport, this site may be subject to aircraft overflights and noise due to aircraft. Current as of 02/01/2021





# SITE PLAN

## THE TOWNES AT BIRCHWOOD AT BRAMBLETON



Van Metre

This rendering is for illustrative purposes only. This is an artist's depiction of the proposed development plans for the project, which development plans are subject to change without notice. The rendering is purely conceptual in nature and should not be relied on in making a decision to purchase. Neither seller nor developer make any representation or warranty of any kind, express or implied, regarding the current or future use of properties surrounding the project or elsewhere in the planned community. This site lies within the Airport Impact Overlay District. Due to its proximity to Washington Dulles International Airport, this site may be subject to aircraft overflights and noise due to aircraft. Current as of 02/16/2021





# SITE PLAN

## THE GRAND VILLAS AT BIRCHWOOD AT BRAMBLETON

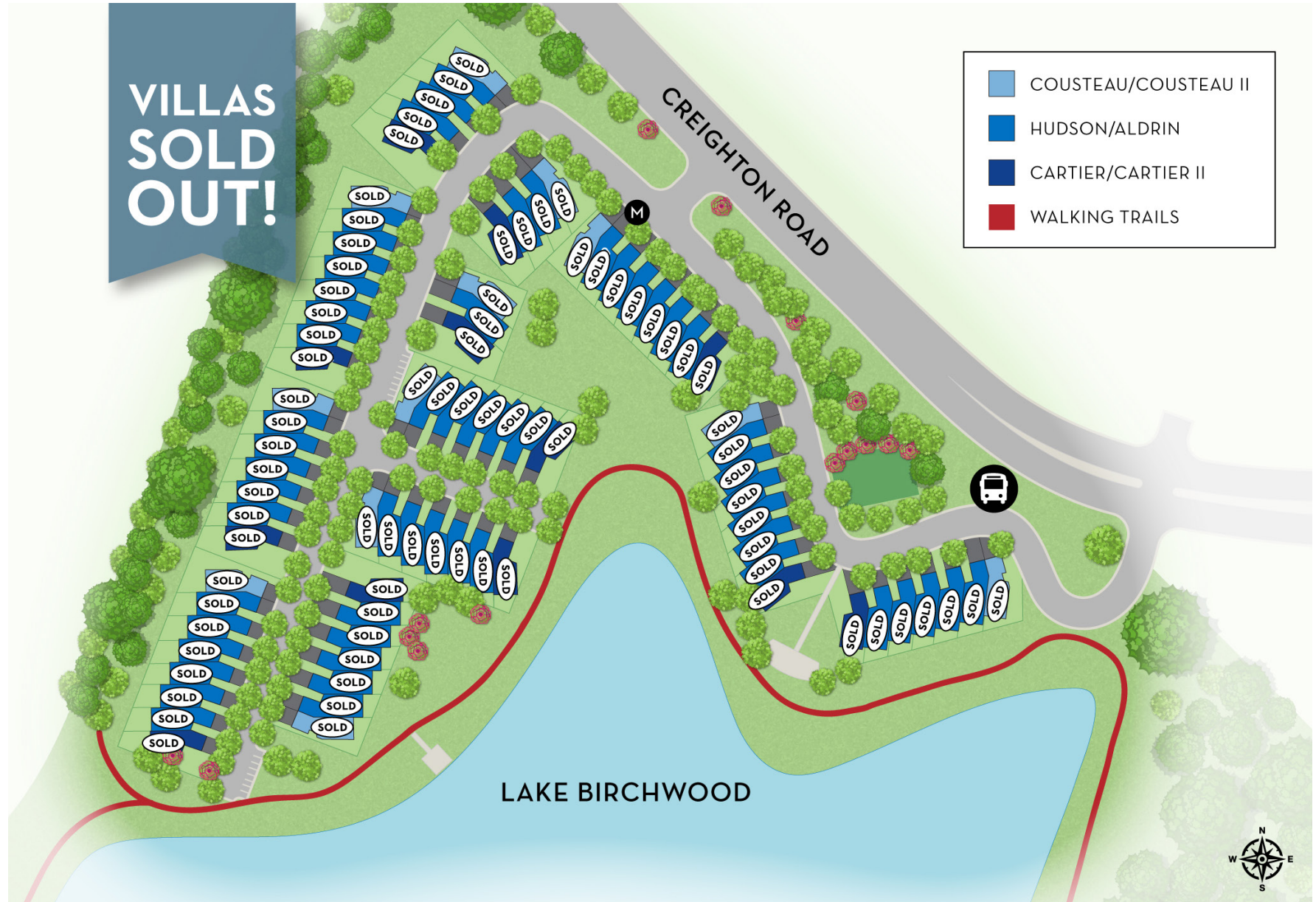

Van Metre

This rendering is for illustrative purposes only. This is an artist's depiction of the proposed development plans for the project, which development plans are subject to change without notice. The rendering is purely conceptual in nature and should not be relied on in making a decision to purchase. Neither seller nor developer make any representation or warranty of any kind, express or implied, regarding the current or future use of properties surrounding the project or elsewhere in the planned community. This site lies within the Airport Impact Overlay District. Due to its proximity to Washington Dulles International Airport, this site may be subject to aircraft overflights and noise due to aircraft. Current as of 03/29/2021





# SITE PLAN

## THE VIEWS COLLECTION AT BIRCHWOOD AT BRAMBLETON



Van Metre

This rendering is for illustrative purposes only. This is an artist's depiction of the proposed development plans for the project, which development plans are subject to change without notice. The rendering is purely conceptual in nature and should not be relied on in making a decision to purchase. Neither seller nor developer make any representation or warranty of any kind, express or implied, regarding the current or future use of properties surrounding the project or elsewhere in the planned community. This site lies within the Airport Impact Overlay District. Due to its proximity to Washington Dulles International Airport, this site may be subject to aircraft overflights and noise due to aircraft. Current as of 05/03/2021

